



INSTRUCTIONS FOR CONDUCTING THE COMPETITIVE EXAM IN A WESTERN LANGUAGE FOR PH.D. STUDENTS – JUNE 2022

The Western language minimum in June 2022 will be conducted online in an electronic system, where each of the PhD students will use their SUSI account provided by their faculty. Using your account you enter the system according to a certain schedule and find the relevant exam jury, published in the electronic course of the exam. This information has also been sent to you as a message in your profile.

I. ACCESS TO THE ELECTRONIC SYSTEM

The electronic system is located at:

<https://elearn.uni-sofia.bg/>

Navigation: [Начална страница](#), [Новини от сайта](#), [Курсове](#)

Main Menu: [Администратори: elearn@uni-sofia.bg](#), [Новини от сайта](#)

Latest News: 12 авг, 21:42, [Модъл Администратор](#), [Използване на Средата за Електронно Обучение и Научния Портал на СУ](#), [По-стари теми ...](#)

ИСТОРИЧЕСКИ ФАКУЛТЕТ Администратор: Симеон Хинковски (hinkovski@uni-sofia.bg)	ФИЛОСОФСКИ ФАКУЛТЕТ Администратори: Антоанета Димитрова, Весела Цокева (elearn@phls.uni-sofia.bg)
ФАКУЛТЕТ ПО КЛАСИЧЕСКИ И НОВИ ФИЛОЛОГИИ Администратор: Симеон Хинковски (hinkovski@uni-sofia.bg)	ФАКУЛТЕТ ПО СЛАВЯНСКИ ФИЛОЛОГИИ Администратор: Ружа Мускурова (ruzha_m@slav.uni-sofia.bg)
ЮРИДИЧЕСКИ ФАКУЛТЕТ Администратор: Симеон Хинковски (hinkovski@uni-sofia.bg)	ФАКУЛТЕТ ПО ПЕДАГОГИКА Администратор: Стоян Съев
ФАКУЛТЕТ ПО НАУКИ ЗА	ФАКУЛТЕТ ПО

Ph.D. students enter the system with the user name from the "Login" menu located in the upper-right corner of the screen.

Не сте влезли в системата. (Вход)

In the two fields that will appear, please, fill in the user name and password:



СОФИЙСКИ УНИВЕРСИТЕТ
„СВ. КЛИМЕНТ ОХРИДСКИ“

Потребителско име

Парола

Запомняне на име и парола

Вход

Забравени потребителско име или парола?

Бисквитките трябва да са разрешени във Вашия браузър ?

Някои курсове могат да допускат достъп като гост

Вход като гост

ii. ACCESS TO THE EXAM JURY

Upon entering the system, in the section "My courses" the relevant jury will appear on the page of each of the Ph.D. students:

Elearn FCML English (en) Simeon Hinkovski

Customise this page

Navigation

- Dashboard
- Site home
- Site pages
- My courses
- Engl_1

Administration

- Site administration

Search

Recently accessed courses

Кандидат-докторантски изпити по зап... | Engl_1
АНГЛИЙСКИ ЕЗИК - I КОМИСИЯ

Private files

Methodology-guide-18.04.2019_Cyprus.pdf

Manage private files...

Course overview

Timeline

No upcoming activities due

Online users

1 online user (last 5 minutes)
Simeon Hinkovski

Latest badges

You have no badges to display



The doctoral student shall select the jury and enter the course. Then, please, select the Blue Button with your name and hour for exam, and in new window click on “Join session” button and follow the instructions of the jury:

The screenshot shows a web browser window with the URL elearn.fcml.uni-sofia.bg/mod/bigbluebuttonbn/view.php?id=232&forceview=1. The page title is "Английски език - I комисия". The main content area displays "Английски език, комисия 1" and a message: "This conference room is ready. You can join the session now." A blue button labeled "Join session" is circled in red. Below it, there is a "Recordings" section with the text "There are no recording to show." A sidebar on the left contains navigation options like "Моето табло", "Начална страница", and "Моите курсове".

The PhD. student must enter by pressing on the microphone (upon initial entry, the browser will ask you to allow the microphone, so allow it) and after passing an echo test, press on the green thumb to contact the commission:

The screenshot shows the BigBlueButton interface. A dialog box is open in the center with the title "Как желаете да се включите?". It contains two options: "Със звук" (represented by a microphone icon) and "Като слушател" (represented by a headset icon). The background shows a chat window on the left with messages like "Welcome to 8.10.2020!" and "For help on using BigBlueButton see these (short) tutorial videos." The main area displays the BigBlueButton logo and various controls for audio, video, and screen sharing.

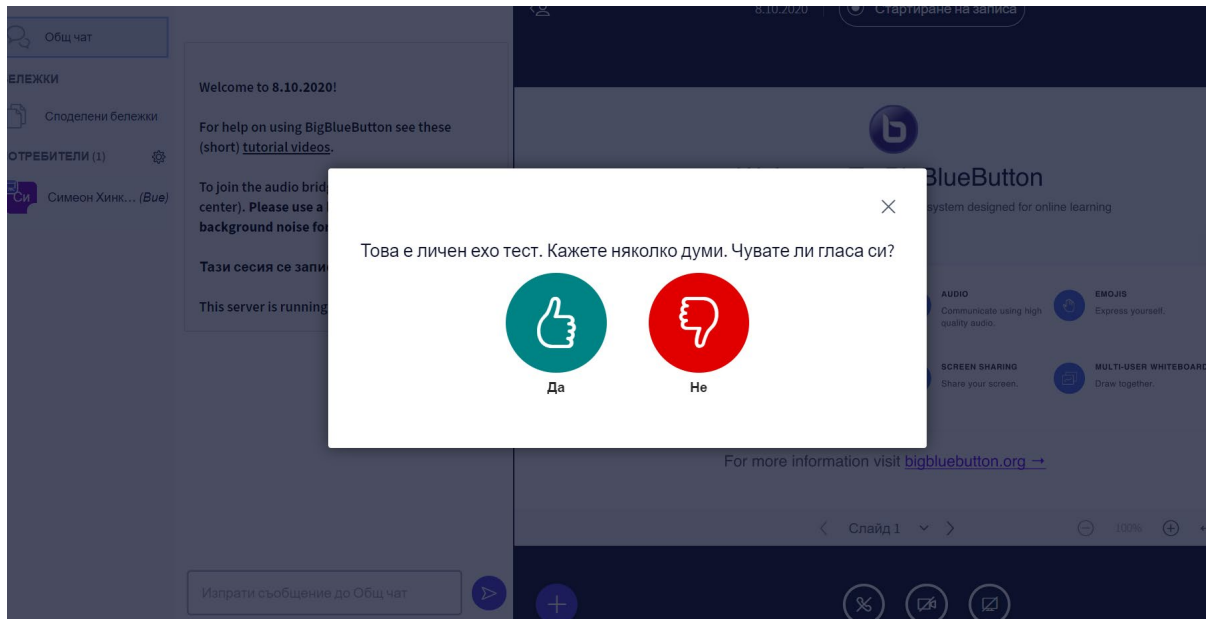

iii. REQUIREMENTS:

Ph.D. students have to provide a scientific text of up to 150 printed pages of a publication in the field of the student's Ph.D. If the publication is in electronic format (pdf, epub, etc.), the applicants are kindly asked to send the text, they have chosen, in advance. If students use a printed publication, the committee will select an excerpt from the text on the spot. Ph.D. students have to be able to read and translate (or summarize) the selected part of the text and answer questions related to the grammar and vocabulary in the excerpt. Two days before exam, everyone of PhD students is necessary to upload your text in the course!

ATTENTION: Each of the doctoral students has to contact the faculty officer in good time before the exam and make sure that their profile works. In certain cases, you will need to enter an active email in which you will receive a link to confirm your account. Only then will you be admitted to the courses. You should complete this procedure not later than 2 hours before the exam in order not to disrupt the established schedule of the exam jury !!!

Should any problems regarding entering the system occur, please, contact Sr. Asst. Simeon Hinkovski, Ph.D., e-mail: hinkovski@uni-sofia.bg, or in phone +359 878-79-26-47.